

PC Card 15Pin Conn Series

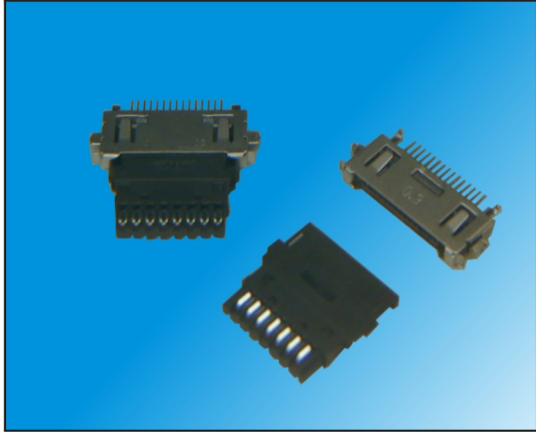

**Material : High Tempure Termoplastic
Black , UL94V-0**
Contact : Phosphor Bronze
Metal Shell : Stainless
**Insert : PBT + 30%Glass Fiber
94V-0**

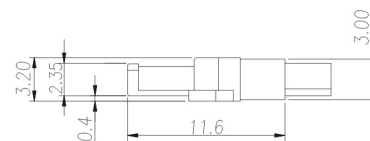
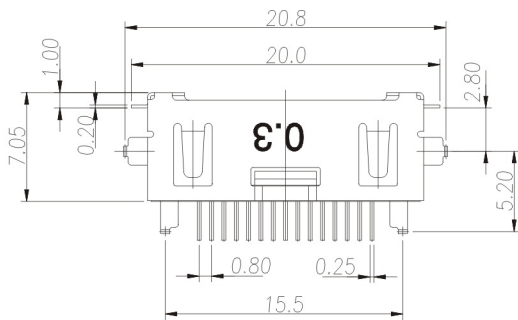
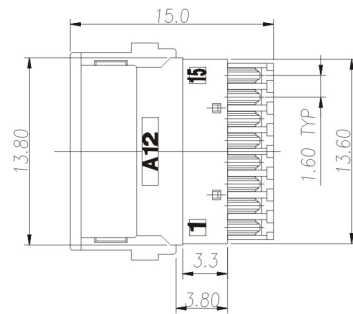
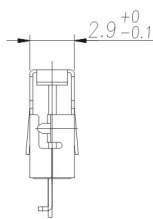
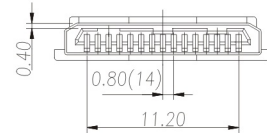
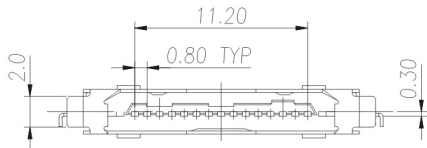

How To Order

Series No.
P C 1 5
15Pin Connector
Pitch=0.8mm

Contact Type
B
B:Board Side Connector
C:Board Side Connector

Key Type
(Board Side / Cable Side)
1
1:A3 Type / A12 Type
2:A2 Type / A13 Type
3:A1 Type / A23 Type
4:A0 Type / A0 Type
5:B3 Type / B12 Type
6:B2 Type / B13 Type
7:B1 Type / B23 Type
8:B0 Type / B0 Type

Type Number.
0 1
01 ~ 99